

EN

INSTRUCTIONS
FAN HEATER



Table of contents

Information on the use of these instructions	2
Safety	2
Information about the device	5
Transport and storage	6
Assembly and start-up	7
Operation	8
Errors and faults	11
Maintenance	12
Technical annex	14
Disposal	16

Information on the use of these instructions

Symbols



Warning of electrical voltage

This symbol indicates dangers to the life and health of persons due to electrical voltage.



Warning of hot surface

This symbol indicates dangers to the life and health of persons due to hot surface.



Warning

This signal word indicates a hazard with an average risk level which, if not avoided, can result in serious injury or death.



Caution

This signal word indicates a hazard with a low risk level which, if not avoided, can result in minor or moderate injury.

Notice

This signal word indicates important information (e.g. material damage), but does not indicate hazards.



Info

Information marked with this symbol helps you to carry out your tasks quickly and safely.



Follow the manual

Information marked with this symbol indicates that the instructions must be observed.

You can download the current version of the instructions and the EU declaration of conformity via the following link:

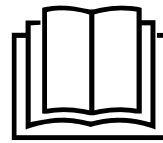

TFC 21 E



<https://hub.trotec.com/?id=46388>

Safety

Read this manual carefully before starting or using the device. Always store the manual in the immediate vicinity of the device or its site of use.



Warning

Read all safety warnings and all instructions.

Failure to follow the warnings and instructions may result in electric shock, fire and/or serious injury.

Save all warnings and instructions for future reference.

This appliance can be used by children aged from 8 years and above and persons with reduced physical, sensory or mental capabilities or lack of experience and knowledge if they have been given supervision or instruction concerning use of the appliance in a safe way and understand the hazards involved. Children shall not play with the appliance. Cleaning and user maintenance shall not be made by children without supervision.



Warning

Children of less than 3 years should be kept away from the device unless continuously supervised.

Children aged from 3 years and less than 8 years shall only switch on/off the appliance provided that it has been placed or installed in its intended normal operating position and they have been given supervision or instruction concerning use of the appliance in a safe way and understand the hazards involved.

Children aged from 3 years and less than 8 years shall not plug in, regulate and clean the appliance or perform user maintenance.



Warning

Do not use the device in small rooms if persons are present who cannot leave the room independently and who are not under constant supervision.

- Do not use the device in potentially explosive rooms or areas and do not install it there.
- Do not use the device in aggressive atmosphere.

- Place the device in an upright and stable position on horizontal and stable ground.
- Let the device dry out after a wet clean. Do not operate it when wet.
- Do not use the device with wet or damp hands.
- Do not expose the device to directly squirting water.
- Never insert any objects or limbs into the device.
- Do not cover the device during operation.
- Do not remove any safety signs, stickers or labels from the device. Keep all safety signs, stickers and labels in legible condition.
- Do not sit on the device.
- This appliance is not a toy. Keep away from children and animals.
- Check accessories and connection parts for possible damage prior to every use of the device. Do not use any defective devices or device parts.
- Ensure that all electric cables outside of the device are protected from damage (e.g. caused by animals). Never use the device if electric cables or the power connection are damaged!
- The mains connection must correspond to the specifications in the Technical annex.
- Insert the mains plug into a properly fused mains socket.
- Observe the device's power input, cable length and intended use when selecting extensions to the power cable. Completely unroll extension cables. Avoid electrical overload.
- Before carrying out maintenance, care or repair work on the device, remove the mains plug from the mains socket. Hold onto the mains plug while doing so.
- Switch the device off and disconnect the power cable from the mains socket when the device is not in use.
- Do not under any circumstances use the device if you detect damages on the mains plug or power cable. If the power cable is damaged, it must be replaced by the manufacturer, its service agent or similarly qualified persons in order to avoid a hazard. Defective power cables pose a serious health risk!
- When positioning the device, observe the minimum distances from walls and other objects as well as the storage and operating conditions specified in the Technical annex.
- Keep a safety distance of at least 1 m between the air inlet and the air outlet of the device and all combustible materials such as textiles, curtains, beds and sofas.
- Make sure that the air inlet and outlet are not obstructed.
- Make sure that the suction side is kept free of dirt and loose objects.
- Do not place the device on combustible ground.
- Only use original spare parts, for otherwise safe and functional operation cannot be ensured.
- Allow the device to cool down before transport and/or maintenance work.
- The device must not be positioned directly beneath a wall socket.
- Do not use the device if it has been dropped or if it shows visible signs of damage.
- Use the CR 2032 button battery type.
- Do not insert rechargeable batteries into the remote control.
- Never charge batteries that cannot be recharged.
- Different types of batteries and new and used batteries must not be used together.
- Insert the batteries into the battery compartment according to the correct polarity.
- Remove discharged batteries. Batteries contain materials hazardous to the environment. Dispose of the batteries according to the national regulations.
- Remove the batteries from the remote control if you will not be using the device for a longer period of time.
- Never short-circuit the supply terminal in the battery compartment!
- Do not swallow batteries! If a battery is swallowed, it can cause severe internal burns within 2 hours! These burns can lead to death!
- If you think batteries might have been swallowed or otherwise entered the body, seek medical attention immediately!
- Keep new and used batteries and an open battery compartment away from children.
- If the battery compartment does not close securely, stop using the product via the remote control.

Intended use

The device is only suitable for well insulated spaces or occasional use.

The fan heater serves the purpose of heating and ventilating closed rooms. The device was designed for private usage and is not suited for commercial use. The device is particularly well suited for additional heating. The device is only intended for floor installation.

Any use other than the intended use is regarded as misuse.

Reasonably foreseeable misuse

- Do not place the device on wet or flooded ground.
- Do not place any objects, e.g. clothing, on the device.
- Do not use this device in the vicinity of fuel, solvents, varnishes or other easily inflammable vapours or in rooms where these substances are stored.
- Do not use the device out of doors.
- Do not use the device for heating vehicles.
- Do not use the heating device in immediate vicinity of swimming pools, bathtubs and showers.
- Never immerse the device in water.
- Never heat rooms with a cubature of less than 4 m³. Risk of overheating!
- Do not make any unauthorised modifications, alterations or structural changes to the device.



Personnel qualification

People who use this device must:

- be aware of the dangers that occur when working with electric devices in damp areas.
- have read and understood the instructions, especially the Safety chapter.

Maintenance tasks which require the housing to be opened must only be carried out by specialist electrical companies or by Trotec.

Symbols on the device

Symbols	Meaning
	This symbol located on the device indicates that it is prohibited to place objects (such as towels, clothes etc.) above or directly in front of the device. In order to avoid overheating and fire hazards, the heater must not be covered.
	This symbol located on the device indicates that this label has to be removed before the foot is mounted.

Residual risks



Warning of electrical voltage

Work on the electrical components must only be carried out by an authorised specialist company!



Warning of electrical voltage

Before any work on the device, remove the mains plug from the mains socket!
Do not touch the mains plug with wet or damp hands. Hold onto the mains plug while pulling the power cable out of the mains socket.



Warning of electrical voltage

Risk of electric shock!
The device is not protected against water. There is a risk of electric shock!
Never use the device in areas where dripping, spraying or running water can enter the device! Never immerse the device in water!



Warning of hot surface

Parts of this appliance can become very hot and cause burns. Particular attention is to be paid when there are children or vulnerable persons present!



Warning

Improper handling entails a risk of burning and electric shock.
Only use the device as intended!



Warning

Dangers can occur at the device when it is used by untrained people in an unprofessional or improper way! Observe the personnel qualifications!



Warning

The device is not a toy and does not belong in the hands of children.



Warning

Risk of suffocation!
Do not leave the packaging lying around. Children may use it as a dangerous toy.



Warning

Improper installation entails a risk of fire.
Do not place the device on combustible ground.
Do not place the device on high-pile carpets.



Warning

In order to avoid overheating and fire hazards, the device must not be covered!

Behaviour in the event of an emergency

1. Switch the device off.
2. Disconnect the device from the mains: Hold onto the mains plug while pulling the power cable out of the mains socket.
3. Do not reconnect a defective device to the mains.

Overheating protection

The device is provided with a safety thermostat which is activated by overheating of the device (when exceeding the operating temperature).

Once the safety thermostat has switched itself on, the device will be turned off.

When the device has cooled down sufficiently, it has to be switched back on manually.

Investigate the cause of overheating.

If the safety thermostat does not switch in the event of overheating, the overheating protection will be tripped. In that case the device switches off completely. If so, please contact the customer service to have the overheating protection replaced.

Tilt protection

The device comes equipped with a tilt protection sensor. The tilt protection is a safety device intended to minimize the risk of fire in case the device is tipped over inadvertently. The device will be switched off when knocked over (or if its upright position is changed in any other manner).

The tilt protection switches the device off when it is inclined by a few degrees out of its vertical position. The tilt protection is also tripped when lifting the device a little, e.g. for transport during operation. The device can again be used as usual only a few seconds after placing it back in vertical position and on solid ground.

Information about the device

Device description

The ceramic heater serves to generate and distribute warm air, e.g. in interior spaces.

The device generates heat by means of a ceramic heating element. The surrounding air is sucked in and heated in the interior of the heater. The heated air is blown into the room by a fan.

The device is equipped with an integrated thermostat and so generates a constant flow of warm air. In addition, you can set a desired target temperature (15 °C to 35 °C) at the device.

The device is further equipped with an overheating protection and an integrated tilt protection.

Moreover, the device comes with an on-demand 80° oscillation for an even better distribution of the warm air in the room.

In order to dissipate the accumulated heat, the fan keeps running for approx. 30 seconds after the heater's switch-off and then switches off automatically.

The device is not protected against water (IPX0).

Device depiction

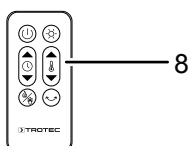
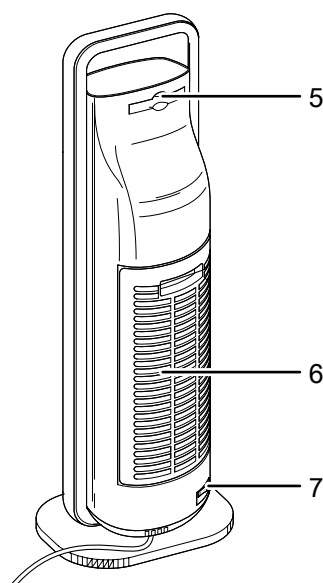
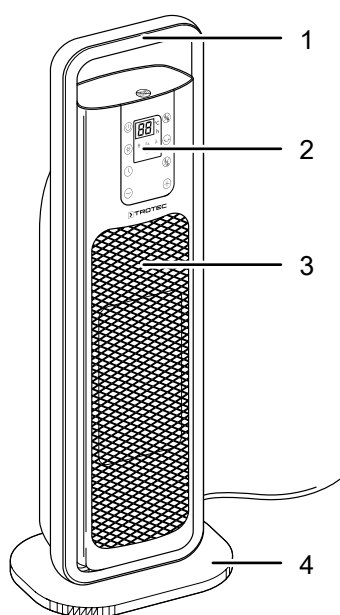

No.	Designation
1	Transport handle
2	Control panel
3	Air outlet
4	Foot
5	Compartment for the remote control
6	Air inlet with air filter
7	On / off switch
8	Remote control

Transport and storage

Notice

If you store or transport the device improperly, the device may be damaged.

Note the information regarding transport and storage of the device.

Transport

To make the device easier to transport, it is fitted with a carry handle.

Before transporting the device, observe the following:

- Switch the device off.
- Hold onto the mains plug while pulling the power cable out of the mains socket.
- Do not use the power cable to drag the device.
- Allow the device to cool down sufficiently.

Storage

Before storing the device, proceed as follows:

- Hold onto the mains plug while pulling the power cable out of the mains socket.
- Allow the device to cool down sufficiently.

When the device is not being used, observe the following storage conditions:

- Store the device in a dry location and protected from frost and heat.
- Store the device in an upright position where it is protected from dust and direct sunlight.
- If required, use a cover to protect the device from invasive dust.
- Place no further devices or objects on top of the device to prevent it from being damaged.
- Remove the batteries from the remote control.

Assembly and start-up

Scope of delivery

- 1 x Fan heater
- 1 x Remote control
- 1 x Foot
- 1 x Manual

Unpacking the device

1. Open the cardboard box and take the device out.
2. Completely remove the packaging.
3. Fully unwind the power cable. Make sure that the power cable is not damaged and that you do not damage it during unwinding.

Assembly



Warning

Risk of fire due to improper installation!
There is a risk of fire if the required minimum distances are not observed.
Observe the "Installation" section in the "Assembly and start-up" chapter and the technical data in the "Technical annex" chapter.

Foot assembly

1. Set up the foot (4).
2. Remove the sticker at the bottom of the device before mounting the foot.
3. Attach the device on the foot (4) from above so that the clips (9) on the device are exactly aligned with the recesses at the foot (4).

4. Press the device down to fasten it on the foot (4).

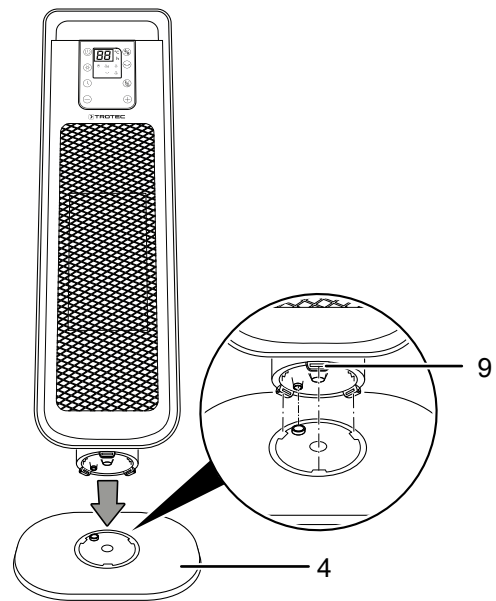

⇒ The foot (4) clicks into place on the clips (9) of the device.

5. Check the foot (4) for tight fit.
6. Set the device up in an upright and stable position.

Start-up



Info

Odours might arise upon initial start-up or after a longer period of non-use.

When positioning the device, observe the minimum distance from walls or other objects as described in the chapter Technical annex.

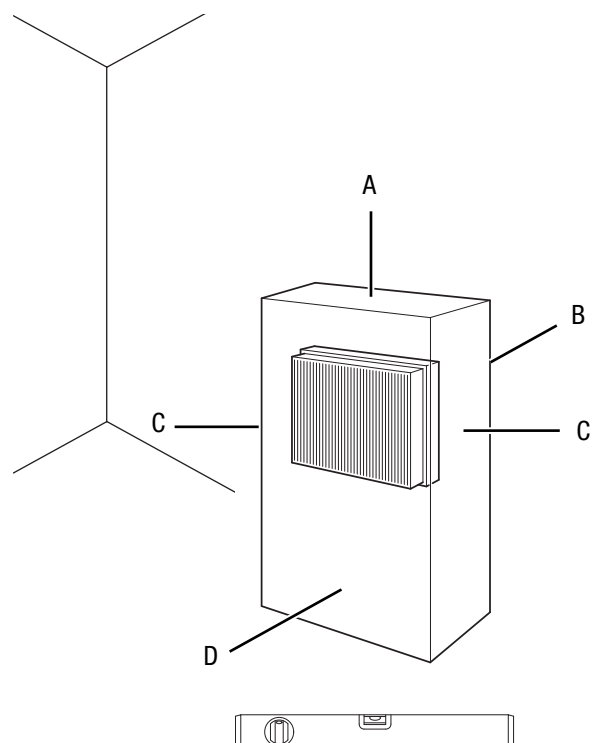

- Before starting the device, check the condition of the power cable. If there are doubts as to their sound condition, contact the customer service.
- Set the device up in an upright and stable position.
- Do not create tripping hazards when laying the power cable or other electric cables, especially when positioning the device in the middle of the room. Use cable bridges.
- Make sure that extension cables are completely unrolled.
- Make sure that no curtains or other objects interfere with the air flow.
- Do not position the device directly below a wall socket.
- Make sure that the device cannot come into contact with moisture or water.

Inserting the air filter

Notice

Do not operate the device without an air filter inserted into the air inlet!

Without the air filter, the inside of the device will be heavily contaminated. This can reduce the performance and result in damage to the device.

- Make sure that the air filter is installed before switching the device on (see chapter Cleaning the air filter).

Inserting a battery into the remote control



Warning of electrical voltage

Do not touch the battery compartment with wet or damp hands.

Notice

Do not use rechargeable batteries!

Observe the Technical data for start-up.

1. Press the upper part on the back of the remote control and pull the battery cover off the remote control.
2. Insert a CR 2032 battery into the battery compartment adhering to the correct polarity.
3. Slide the battery cover back onto the remote control.

Connecting the power cable

- Insert the mains plug into a properly fused mains socket.
- Make sure that the power cable is guided along the back of the device. Never guide the power cable along the front of the device!

Operation

- Avoid open doors and windows.

Control panel

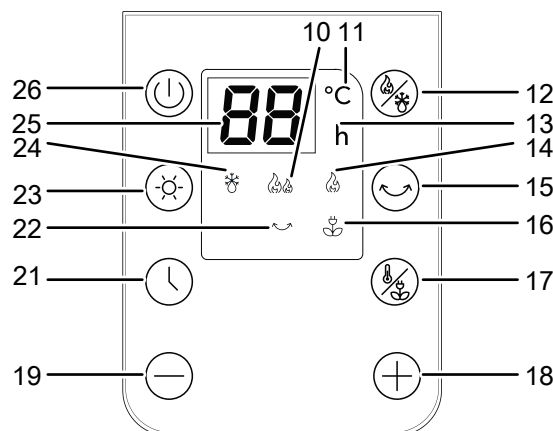

Remote control

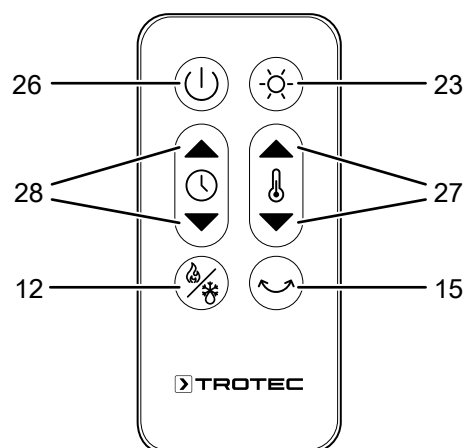

No.	Designation	Meaning
10	Heating level 2 LED	Is illuminated when heating level 2 (2000 W) is activated
11	Temperature LED	Is illuminated when temperature adjustment is activated
12	Mode button	For selecting the operating mode: Heating function Frost monitor function
13	Timer LED	Is illuminated when automatic switch-on or switch-off has been activated
14	Heating level 1 LED	Is illuminated when heating level 1 (1300 W) is activated
15	Oscillation button	Switching oscillation on or off
16	ECO mode LED	Is illuminated when the ECO mode is activated

No.	Designation	Meaning
17	<i>ECO mode</i> button	Switching the ECO mode on or off Set the desired room temperature (15 °C to 35 °C)
18	<i>Increase value</i> button	Set the desired room temperature (15 °C to 35 °C) or increase the set number of hours when the timer is activated
19	<i>Decrease value</i> button	Set the desired room temperature (15 °C to 35 °C) or reduce the set number of hours when the timer is activated
21	<i>Timer</i> button	Switching the timer function on and off: 1 h to 24 h in increments of 1 h
22	<i>Oscillation</i> LED	Is illuminated when the oscillation function is activated
23	<i>Illumination</i> button	Switching illumination of the display on or off
24	<i>Frost monitor function</i> LED	Is illuminated when the frost monitor function is activated
25	Segment display	Indication of the desired temperature and/or the set number of hours of the timer
26	<i>On/Standby</i> button	Switching the device on or off
27	<i>Temperature</i> button	Decreasing or increasing the desired room temperature (15 °C to 35 °C)
28	<i>Timer</i> button	Switching the timer function on and off: 1 h to 24 h in increments of 1 h Decreasing or increasing the set number of hours of the timer



Info

After approx. 1 minute without any input, the display is dimmed automatically.

Switching the device on

Once you have completely installed the device as described in the chapter Assembly and start-up, you can switch it on.

1. Set the mains switch (7) to position I.
⇒ The device is now in standby mode.
2. Press the *On/Standby* button (26).
⇒ An acoustic signal is emitted.
⇒ The room temperature set is indicated on the segment display (25).
⇒ The device is switched on.

Setting the operating mode

The device comes with the following operating modes:

- Heating function
- Frost monitor function
- ECO mode

Heating function

Please proceed as follows to activate the heating function:

- ✓ The device is switched on.
- 1. Press the *Mode* button (12) until the LED for the desired heating level is lit.
⇒ The heating level selected is activated and the device starts to heat. *Heating level 2* is activated with a delay of 10 seconds.

Frost monitor function

- ✓ The device is switched on.
- 1. Press the *Mode* button (12) until the *Frost monitor function* LED (24) is lit.
Remote control: Press the *Mode* button (12) for approx. 3 seconds to use the frost monitor function.
⇒ The device automatically maintains the temperature at 7 °C. This temperature cannot be changed.

Saving mode (ECO)

- ✓ The device is switched on.
- 1. Press the *ECO mode* button (17).
⇒ The *ECO mode* LED (16) is lit.
⇒ The device adapts the heating level automatically to the room temperature.
⇒ The device automatically operates at *Heating level 2* if the room temperature is 18 °C or below.
⇒ The device automatically operates at *Heating level 1* if the temperature is above 18 °C and below 25 °C.
⇒ The device stops heating automatically if the room temperature is above 25 °C.

Notice

The temperature settings cannot be changed in this operating mode.

Setting the desired room temperature

The desired room temperature is indicated on the segment display (25). You can adjust the desired room temperature in the *ECO mode*. Setting is possible in the range between 15 °C and 35 °C in increments of 1 °C.

1. Press the *ECO mode* button (17) twice until the Temperature LED (11) flashes.
⇒ The segment display (25) flashes.
2. Press the *Increase value* (18) or *Decrease value* button (19) to adjust the room temperature.
⇒ The room temperature set is saved and indicated on the segment display (25) for approx. 5 seconds.
⇒ The device switches off automatically upon reaching the set room temperature. When the room temperature falls 2 °C below the temperature set, the device switches on again automatically.

Setting the timer

The timer has the following modes of operation:

- Automatic switch-on upon expiry of a preset number of hours
- Automatic switch-off upon expiry of a preset number of hours

The time to be set can be between 1 and 24 hours and is adjustable in increments of 1 h.

Notice

The device must not be left unattended in a freely accessible room with an activated timer.

Automatic switch-on

- ✓ The device is now in standby mode. The frost monitor function may possibly be activated.
1. Press the *Timer* button (21).
 2. Press the *Increase value* (18) or *Decrease value* button (19) to set the desired set number of hours until automatic switch-on.
⇒ The set number of hours flashes in the segment display (25).
⇒ The Timer LED (13) is illuminated.
 3. Press the *Timer* button (21) again.
⇒ The timer has been programmed and the device will switch on after the predefined time.

Notes regarding automatic switch-on:

- Manually switching the device on disables the automatic switch-on function.
- If you select 00 hours, the timer will be switched off.

Automatic switch-off

Notice

In order to dissipate the accumulated heat, the fan keeps running for approx. 30 seconds after the device has been switched off and then switches off automatically.

- ✓ The device is switched on. The heating function, frost monitor function or the ECO mode may be activated.
1. Press the *Timer* button (21).
 2. Select the *Increase value* (18) or *Decrease value* button (19) to set the desired set number of hours until automatic switch-off.
⇒ The set number of hours flashes in the segment display (25).
⇒ The Timer LED (13) is illuminated.
 3. Press the *Timer* button (21) again.
⇒ The timer has been programmed and the device will switch to standby after the predefined time.

Notes regarding automatic switch-off:

- Manually switching the device off disables the automatic switch-off function.
- If you select 00 hours, the timer will be off.

Memory function



Info

In the Standby mode, the device memorises the room temperature set.

Switch off the device without disconnecting it from the power supply. The activated function at switch-off will be started again automatically when the device is switched on the next time. The Timer function is an exception to this.

Notice

All settings can be adjusted via the remote control.

Switching the display on and off

Please proceed as follows to switch the control panel (2) on or off:

1. Press the *Illumination* button (23) to switch the display off.
⇒ The display switches off.
2. Press any button to switch on the device.
⇒ The display switches on.

Using the oscillation function

Notice

Oscillation can only be set with the heating function activated.

- ✓ The device is switched on.
- ✓ The device is in heating mode.
- 1. Press the *Oscillation* button (15) once to activate the oscillation function.
 - ⇒ The oscillation function is activated.
 - ⇒ The device turns to and fro by up to 80°.
- 2. Press the *Oscillation* button (15) again to deactivate the oscillation function.
 - ⇒ The oscillation function is deactivated.

Shutdown



Warning of electrical voltage

Do not touch the mains plug with wet or damp hands.

Notice

In order to dissipate the accumulated heat, the fan keeps running for approx. 30 seconds after the device has been switched off and then switches off automatically.

After 12 operating hours, the device switches off automatically.

The illumination of the display is dimmed after 1 minute if no buttons are pressed.

1. Switch off the device by pressing the On/Standby button (26).
 - ⇒ The fan keeps running.
2. Set the on/off switch (7) to 0.
 - ⇒ The device is switched off.
3. Allow the device to cool down sufficiently.
4. Hold onto the mains plug while pulling the power cable out of the mains socket.
5. Clean the device according to the Maintenance chapter.
6. Store the device according to the Storage chapter.

Errors and faults



Warning of electrical voltage

Tasks which require the device to be opened must only be carried out by authorised specialist companies or by Trotec.

Notice

Wait for at least 3 minutes after maintenance and repair work. Only then switch the device back on.

The device has been checked for proper functioning several times during production. If malfunctions occur nonetheless, check the device according to the following list.

The device does not start:

- Check the power connection.
- Check the power cable and mains plug for damage. If you notice damages, do not try to take the device back into operation.

If the supply cord is damaged, it must be replaced by the manufacturer, its service agent or similarly qualified persons in order to avoid a hazard.
- Check the on-site fusing.
- Check the room temperature. The room thermostat may have switched off, because the desired room temperature has been reached.
- The motor might be defective. Have a defective motor replaced by a specialist electrical company.
- Check whether the device is standing upright and on level ground. The tilt protection may have been tripped owing to the fact that the device was knocked over. Always put up the device in an upright position on a suitable, sufficiently dimensioned surface.
- The room thermostat might be defective. Have a defective room thermostat replaced by a specialist electrical company.
- The overheating protection may have been tripped. Have a specialist electrical company or Trotec check the electrics and replace the overheating protection.

The fan is not running:

- Check whether the device is switched on.
- Check the power connection.
- Check the power cable and mains plug for damages.
- The fan motor might be defective. Have a defective fan motor replaced by a specialist electrical company.

The air current is reduced:

- Check the air inlet and outlet. Make sure that air inlet and outlet are not obstructed. Remove any dirt. Observe the minimum distance from walls or other objects according to the technical data.

The device is loud or is losing performance:

- Check the air filter for dirt. If necessary, clean or replace the air filter.

The device is loud or vibrates:

- Check whether the device is set up in a stable and upright position.

The device does not respond to the infrared remote control:

- Check whether the distance between remote control and device is too large and reduce it if necessary.
- Make sure there are no obstacles, such as furniture or walls, between the device and the remote control. Ensure visual contact between device and remote control.
- Check the charging status of the batteries and change them if required.
- If the batteries have just been changed, check them for correct polarity.

The device still does not operate correctly after these checks:

Please contact the customer service. If necessary, bring the device to an authorised specialist electrical company or to Trotec for repair.

Maintenance**Activities required before starting maintenance****Warning of electrical voltage**

Do not touch the mains plug with wet or damp hands.

- Switch the device off.
- Hold onto the mains plug while pulling the power cable out of the mains socket.
- Allow the device to cool down completely.

**Warning of electrical voltage**

Tasks which require the device to be opened must only be carried out by authorised specialist companies or by Trotec.

Cleaning the housing**Warning of electrical voltage**

Never immerse the device in water!

Clean the housing with a soft, damp and lint-free cloth. Make sure that no moisture enters the housing. Protect electrical components from moisture. Do not use any aggressive cleaning agents such as cleaning sprays, solvents, alcohol-based or abrasive cleaners to dampen the cloth.

Wipe the housing dry after cleaning.

Visual inspection of the inside of the device for dirt

1. Remove the air filter.
2. Use a torch to illuminate the openings of the device.
3. Check the inside of the device for dirt.
4. If you see a thick layer of dust, have the inside of the device cleaned by a specialist electrical company or by Trotec.
5. Put the air filter back in.

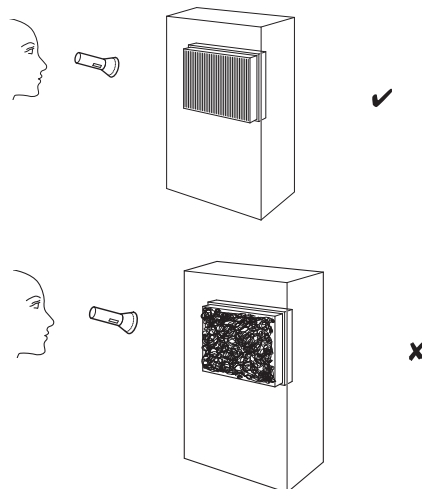

Cleaning the air filter

Notice

Ensure that the air filter is not worn or damaged. The air filter edges must not be deformed. Before reinserting the air filter, make sure that it is undamaged and dry!

The air filter has to be cleaned as soon as it is dirty. This is brought to light e.g. by a reduced capacity (see chapter Errors and faults).

1. Remove the air filter (6) from the device.

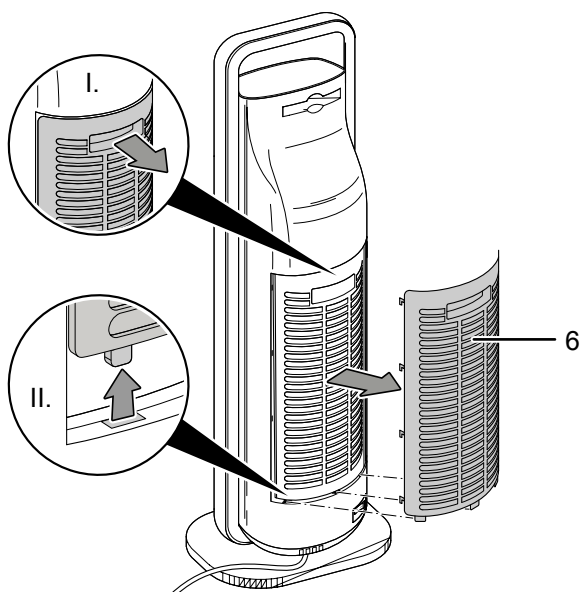

2. Clean the air filter (6) using a slightly damp, soft, lint-free cloth. If the filter is heavily contaminated, clean it with warm water mixed with a neutral cleaning agent.

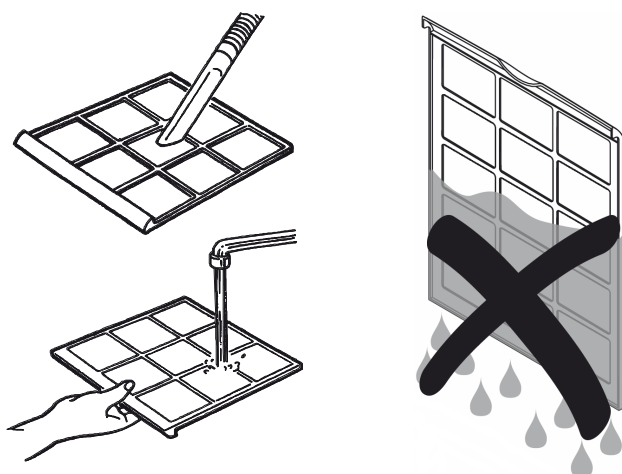

3. Allow the air filter (6) to dry completely. Do not insert a wet filter into the device!
4. Reinsert the air filter (6) into the device.

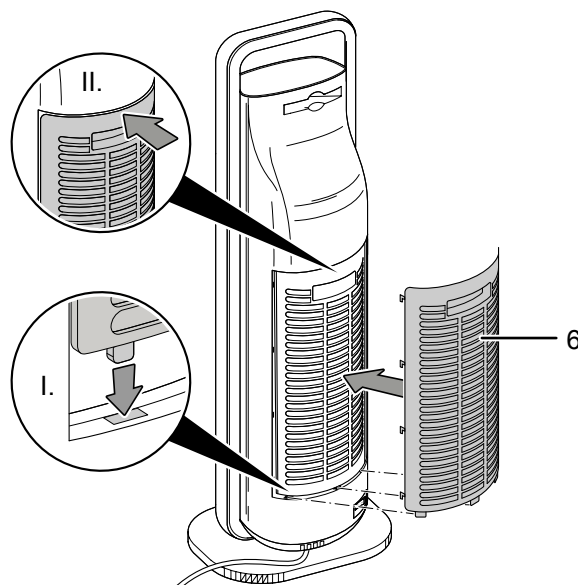

Technical annex

Technical data

Parameter	Value
Model	TFC 21 E
Heating capacity	Level 1: 1300 W Level 2: 2000 W
Operating range	-20 °C to 35 °C
Mains connection	220-240 V / 50-60 Hz
Power consumption, max.	2000 kW
Type of protection	IPX0
Protection class	II / 
Plug type	CEE 7/17
Cable length	1.6 m
Sound pressure level (distance of 1 m)	50 dB
Dimensions with foot (depth x width x height)	178 x 230 x 660 mm
Minimum distance to walls and other objects	A: top: 100 cm B: rear: 100 cm C: side: 100 cm D: front: 100 cm
Weight	3 kg
Remote control batteries	CR 2032

Information requirements for electrical local space heaters

Parameter	Value / item
Model	TFC 21 E
Heat output	
Nominal heat output P_{nom}	2.0 kW
Minimum heat output (indicative) P_{min}	1.3 kW
Maximum continuous heat output $P_{max,c}$	2.0 kW
Auxiliary electricity consumption	
At nominal heat output el_{max}	0
At minimum heat output el_{min}	0
In standby mode el_{sb}	0.00021 kW
Type of heat input	
Manual heat charge control, with integrated thermostat	NA
Manual heat charge control with room and/or outdoor temperature feedback	NA
Electronic heat charge control with room and/or outdoor temperature feedback	NA
Fan assisted heat output	NA
Type of heat output/room temperature control	
Single-stage heat output, no room temperature control	NO
Two or more manual stages, no room temperature control	NO
With mechanic thermostat room temperature control	NO
With electronic room temperature control	YES
With electronic room temperature control plus day timer	NO
With electronic room temperature control plus week timer	NO
Other control options	
Room temperature control, with presence detection	NO
Room temperature control, with open window detection	NO
With distance control option	NO
With adaptive start control	NO
With working time limitation	YES
With black bulb sensor	NO
Contact details	Trotec GmbH Grebbener Straße 7 D-52525 Heinsberg

NA = not applicable

Disposal

Always dispose of packing materials in an environmentally friendly manner and in accordance with the applicable local disposal regulations.



The icon with the crossed-out waste bin on waste electrical or electronic equipment is taken from Directive 2012/19/EU. It states that this device must not be disposed of with the household waste at the end of its life. You will find collection points for free return of waste electrical and electronic equipment in your vicinity. The addresses can be obtained from your municipality or local administration. You can also find out about other return options that apply for many EU countries on the website <https://hub.trotec.com/?id=45090>. Otherwise, please contact an official recycling centre for electronic and electrical equipment authorised for your country.

The separate collection of waste electrical and electronic equipment aims to enable the re-use, recycling and other forms of recovery of waste equipment as well as to prevent negative effects for the environment and human health caused by the disposal of hazardous substances potentially contained in the equipment.



In the European Union, batteries and accumulators must not be treated as domestic waste, but must be disposed of professionally in accordance with Directive 2006/66/EC of the European Parliament and of the Council of 6 September 2006 on batteries and accumulators. Please dispose of batteries and accumulators according to the relevant legal requirements.

Only for United Kingdom

According to Waste Electrical and Electronic Equipment Regulations 2013 (SI 2013/3113) (as amended) and the Waste Batteries and Accumulators Regulations 2009 (SI 2009/890) (as amended), devices that are no longer usable must be collected separately and disposed of in an environmentally friendly manner.

Trotec GmbH

Grebbener Str. 7
D-52525 Heinsberg

☎ +49 2452 962-400

☎ +49 2452 962-200

info@trotec.com

www.trotec.com